



Outdoor Power Equipment: Garden & Forestry



www.zomaxtool.com



ZHEJIANG ZOMAX GARDEN MACHINERY CO.,LTD.

Address: No. 48 Aodihu Road, Taiping Street, Wenling City, Zhejiang Province, China.

Tel: 86 576 8614 6556 / 8614 6558 / 8614 6566

Fax: 86 576 86146567 / 86146568 E-mail: sales@zomaxtool.com



Create a Global Brand To Serve The World



About **ZOMAX**

Established in 2005, ZHEJIANG ZOMAX GARDEN MACHINERY CO., LTD, as a subsidiary of ZOMAX Group, is a professional manufacturer of Outdoor Power Garden Machinery, main products including Gasoline Chainsaw, Gasoline Brush Cutter, and 58V Battery Garden Tools, etc. ZOMAX Garden serves as the National High-tech Enterprise and Zhejiang Standard Innovative Enterprise. The products are widely used in fields such as field courtyards, parks, gardens, trees, orchards, tea gardens, and forestry operations.



ZOMAX LOBBY



ZOMAX GEAR WORKSHOP



ZOMAX WAREHOUSE



ZOMAX STAFF CANTEEN



ZOMAX CULTURE CORNER



Perfect Products Manufacture

In the mass production stage, we always adhere to the principle "3 No" to defective products, they are: "No acceptance, No produce, No delivery". By means of the continuous check to make continuous improvement so as to meet users' needs better.



Forceful R&D Team

ZOMAX always take Innovation R&D as the core competitiveness of the enterprise, we have been committed to the research and development of green and environmentally friendly lithium battery products, and low energy cost gas products. Meanwhile, with the unremitting efforts of R&D teams. At present, ZOMAX Garden has won 11 National Invention Patents, over 150 patents for Utility Models and Appearance, and has built the Provincial-level New High-tech Enterprise Research and Development Center.



▶ Trimmers and Brush Cutters

In growing season, fresh green plants are always awaited, while every bit of growth comes a little bit of maintenance to keep your plants happy and your lawn and garden looking fresh and neat. Here we have the wide option of the brush cutter and grass trimmer and for your needs call. Low vibration, effortless starting, speeding cutting of our models, to make you own one, will have it working long with you.





ENGINES FAMILY

2 Stroke Engine: 25.4cc/32.6cc
42.7cc/51.7cc

4 Stroke Engine: 35.8cc

Variable engines meet your different demands.

4 STROKE ENGINE EuV EPAIII

4 stroke engine uses overhead CAM mechanism, smooth operation, little vibration, low noise, through the optimization of oil system, lubrication system, distribution agencies, heavy parts material, to improve gasoline engine combustion efficiency and to prolong service life. EUIII past without any catalyst. Belongs to the low temperature, energy saving, environmental protection engine.

| | |
|--------------|-----------------|
| Displacement | 35.8 cc |
| Model | 139F |
| Rated Power | 0.8 kW / 1.0 hp |
| Engine | 4 Stroke |

Tooless spark plug cover



Primer exposed, easy to touch.



Double-deck design of muffler cover with heat shield inside.

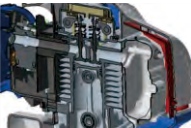

PA6 material fuel tank protector

1E34F EuV EPAIII 2 stroke

| | |
|--------------------|-----------------|
| Displacement | 25.4 cc |
| Bore / Stroke | Φ34 / 28 mm |
| Rated Power | 0.8 kW / 1.0 hp |
| Max Speed | 11,000 rpm |
| Idle Speed | 3,000 ± 300 rpm |
| Fuel Tank Capacity | 500 ml |



Trimmers and
Brush cutters

1E36F EuV EPAIII 2 stroke

| | |
|--------------------|-----------------|
| Displacement | 32.6 cc |
| Bore / Stroke | Φ36 / 32 mm |
| Rated Power | 0.9 kW / 1.2 hp |
| Max Speed | 10,000 rpm |
| Idle Speed | 3,000 ± 300 rpm |
| Fuel Tank Capacity | 650 ml |



1E40F/1E44F EuV EPAIII 2 stroke

| | | |
|--------------------|------------------|-----------------|
| Displacement | 42.7 cc | 51.7 cc |
| Bore / Stroke | Φ40 / 34 mm | Φ44 / 34 mm |
| Rated Power | 1.25 kW / 1.7 hp | 1.4 kW / 1.9 hp |
| Max Speed | 10,000 rpm | 10,000 rpm |
| Idle Speed | 3,000 ± 300 rpm | 3,000 ± 300 rpm |
| Fuel Tank Capacity | 700 ml | 700 ml |



1E40FA/1E44FA EuV EPAIII 2 stroke

| | | |
|--------------------|------------------|-----------------|
| Displacement | 42.7 cc | 51.7 cc |
| Bore / Stroke | Φ40 / 34 mm | Φ44 / 34 mm |
| Rated Power | 1.35 kW / 1.8 hp | 1.5 kW / 2.0 hp |
| Max Speed | 11,000 rpm | 10,000 rpm |
| Idle Speed | 3,000 ± 300 rpm | 3,000 ± 300 rpm |
| Fuel Tank Capacity | 900 ml | 900 ml |

NEW



ZMG2602

CE RoHS EMC EuV EPA III

ZMG2602 has an upgraded engine, is right tool for you to trim rough grass around corners,mail boxes,walls and fences. Gear box and guard design reduce the weight to improve confort. Terse but forceful.



Light weight 4.95 kgs
Without safety guard and cutting equipment

| | |
|--------------|-----------------|
| Displacement | 25.4 cc |
| Rated Power | 0.8 kW / 1.0 hp |
| Dry Weight | 4.95 kg |
| Engine | 2 stroke |



Woollen Air Filter

Tight sealed structure is excellent in dust prevention, but easy to open.



Ergonomic Handle

Rubber part combined with Plastic part, brings comfortable feeling to operator.



Plastic Clutch Com.

for lighter weight.



Brand new driver box Assy

No gap between driver box and trimmer head, effectively reduces the risk of grass blocking.



ZMG2602N2PC

Ideal for trimming edges,working in narrow areas difficult to reach with lawn mowers or tractors to keep your garden tidy and clean.Offer maximum efficiency to allow you to work safely and effortlessly,give you the satisfaction of having a garden perfect in any detail.



| | |
|--------------|-----------------|
| Displacement | 25.4 cc |
| Rated Power | 0.8 kW / 1.0 hp |
| Dry Weight | 5.0 kg |
| Engine | 2 stroke |

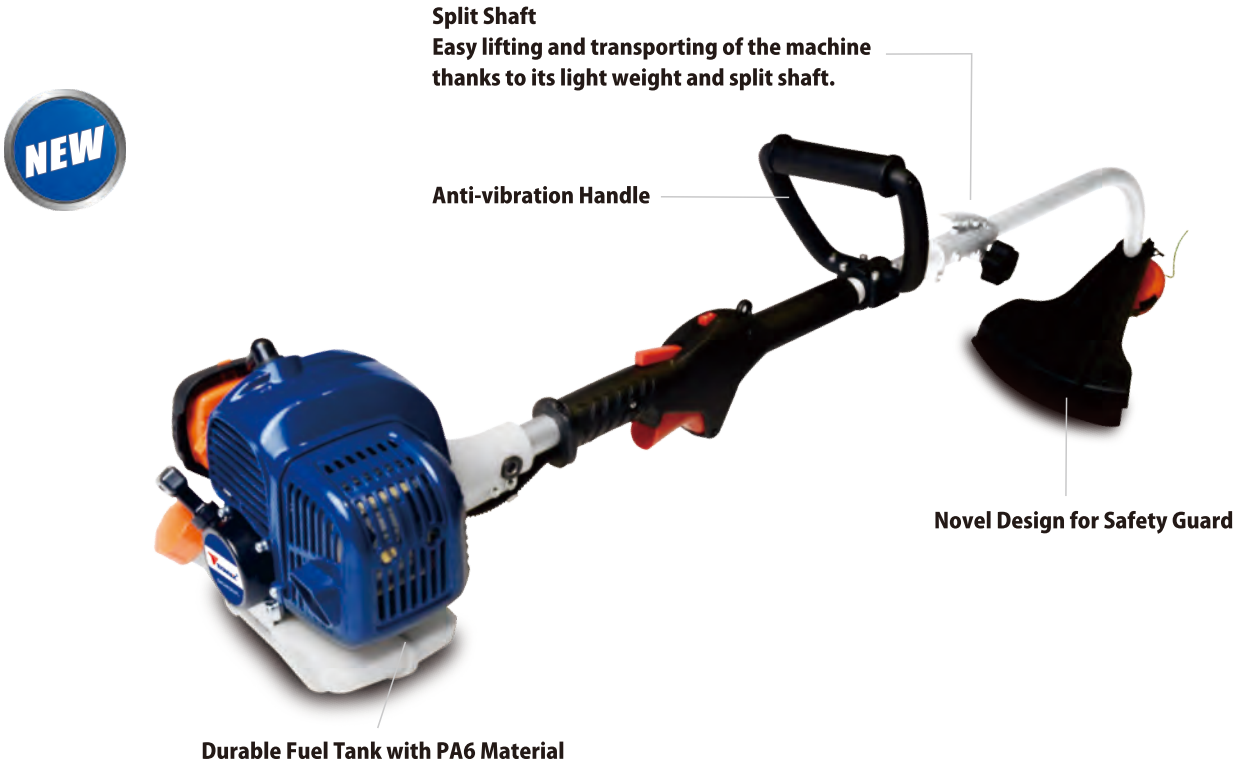

| Model | ZMG2602 | ZMG2602N2PC |
|----------------------------|-------------------------------|-------------------------------|
| Bore (mm) | Φ34 | Φ34 |
| Stroke (mm) | 28 | 28 |
| Displacement (ml) | 25.4 | 25.4 |
| Rated Power (kW) | 0.8 | 0.8 |
| Max Speed (rpm) | 11,000 | 11500±500 |
| Idle Speed (rpm) | 3,000 ± 300 | 3,000 ± 300 |
| Fuel Tank Capacity (ml) | 500 | 500 |
| Dry Weight (kg) | 4.95 | 5.0 |
| Transmission System | Clutch + Hard Shaft + Gearbox | Clutch + Hard Shaft + Gearbox |
| Working Shaft Lengths (mm) | 1,500 | 660 |
| Curved Shaft Lengths (mm) | / | 660 |
| Working Shaft Dia. (mm) | 24 | 26 |
| Drive Shaft Dia. (mm) | 7 | 6 |
| Shaft Teeth | 7 | / |



02 SERIES

ZMG2602/ZMG3302/ZMG4302/
ZMG5302/ZMG3601

Straight working shaft offers a more efficient delivery of the power to the cutting head.

ZMG3302

CE EMC EuV EPA III

To represent 02 SERIES, ZMG3302 is a fuel-efficient powerful trimmer, equipped with straight shaft and U handle. it has perfect balance and an excellent power to weight ratio. High torque for durable operation, specially designed for heavy duty tasks. More, loop handle and detachable shaft versions available for all 02 SERIES.



| | |
|--------------|-----------------|
| Displacement | 32.6 cc |
| Rated Power | 0.9 kW / 1.2 hp |
| Dry Weight | 7.2 kg |
| Engine | 2 stroke |

Loop handle version available

Basic U-handle Settled Seat

One screw to fix with anti-fall-off design

Handle with smooth rubber coating

Detachable shaft version available

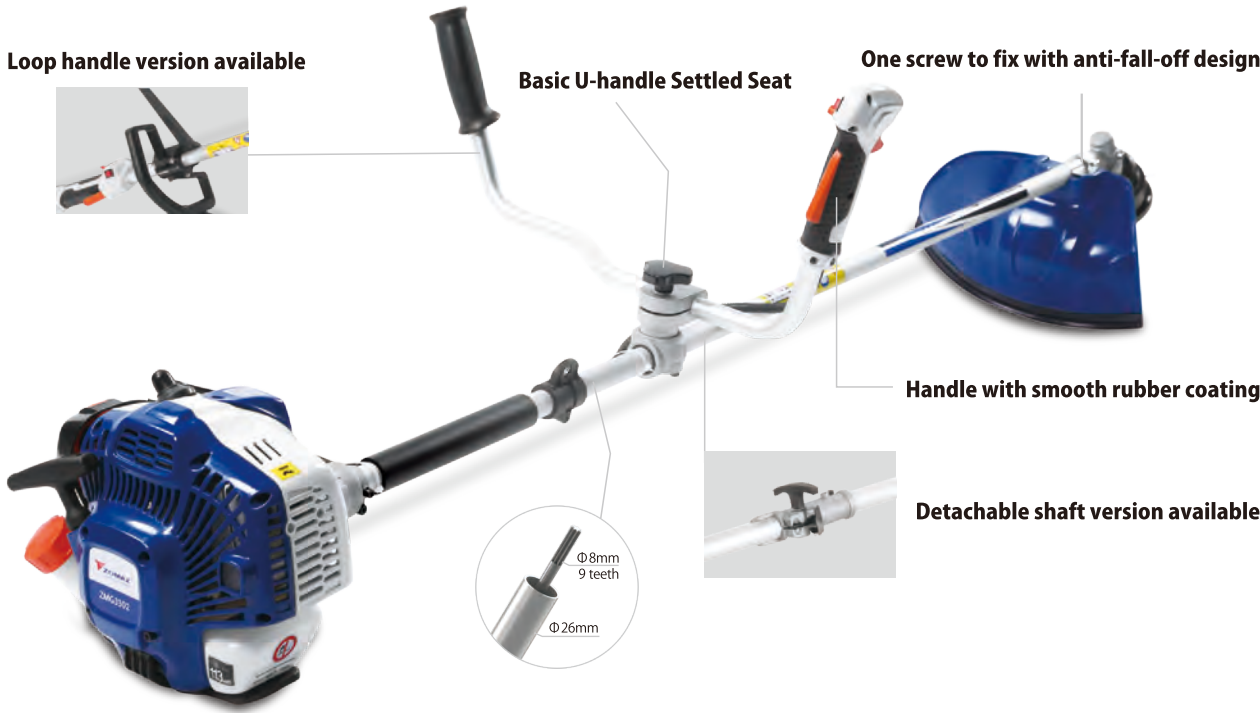

Suitable for following landforms

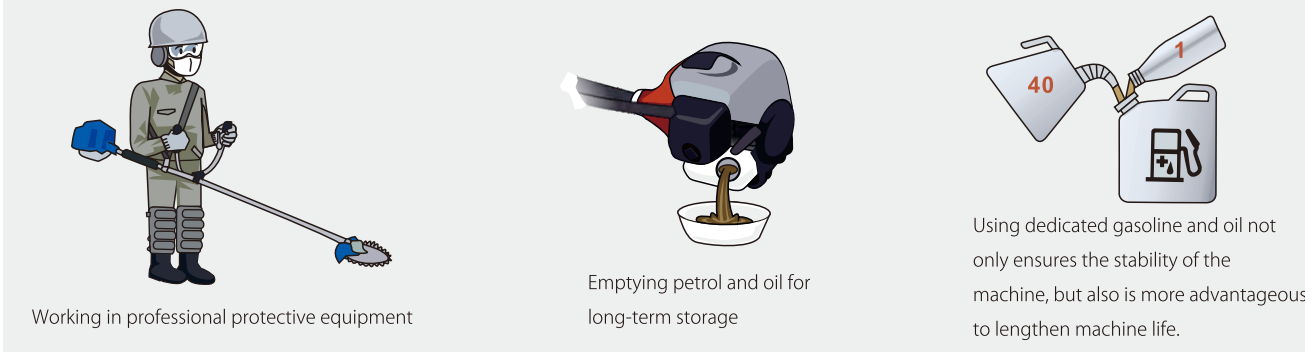

ZMG4302/5302

CE EMC EuV EPA III 2 stroke

| | | |
|-----------------------|---------------------------|---------------------------|
| Displacement | 42.7 cc | 51.7 cc |
| Bore / Stroke | Φ40 / 34 mm | Φ44 / 34 mm |
| Rated Power | 1.25 kW / 1.7 hp | 1.4 kW / 1.9 hp |
| Max Speed | 10,000 rpm | 10,000 rpm |
| Idle Speed | 3,000 ± 300 rpm | 3,000 ± 300 rpm |
| Fuel tank Capacity | 700 ml | 700 ml |
| Dry Weight | 7.5 kg | 7.5 kg |
| Transmission System | Clutch+Hard Shaft+Gearbox | Clutch+Hard Shaft+Gearbox |
| Working Shaft Lengths | 1,500 mm | 1,500 mm |



ZMG3601

CE EMC EuV EPA III 4 stroke

| | |
|-----------------------|---------------------------|
| Displacement | 35.8 cc |
| Bore / Stroke | Φ39 / 30 mm |
| Rated Power | 0.8 kW / 1.0 hp |
| Max Speed | 9,000 rpm |
| Idle Speed | 3,000 ± 300 rpm |
| Fuel tank Capacity | 650 ml |
| Dry Weight | 7.7 kg |
| Transmission System | Clutch+Hard Shaft+Gearbox |
| Working Shaft Lengths | 1,500 mm |



- Model + "T": Low emission engine with catalyst. Naming example: ZMG3302T
- Dry weight is without cutting attachments and safety guard.
- Reference weight: safety guard 390g, nylon head 360g, 3T blade 255g.
- Carton Dimension: 184*28.5* (10/28.5)cm whole packing, 62.5*22*26.5cm+167.5*13*14cm separating packing.

- Standard Accessory: Φ2.5*430 mm, 1.4/2.0*255mm, refer to P49



03 SERIES

ZMG3303/4303/5303/3603

The added clutch cover with rubber surface extends the contact area to reduce the vibration, it relieves the fatigue of waist well. More easier adjust handle swivels for easy storage and transport.

ZMG4303

Compared with 02 SERIES, the extra anti-vibration system clutch cover brings more comfortable. With Easy starter, ergonomic bike handle and professional-grand trimmer angle for working on large areas of tough grass.



| | |
|--------------|------------------|
| Displacement | 42.7 cc |
| Rated Power | 1.25 kW / 1.7 hp |
| Dry Weight | 8.4 kg |
| Engine | 2 stroke |

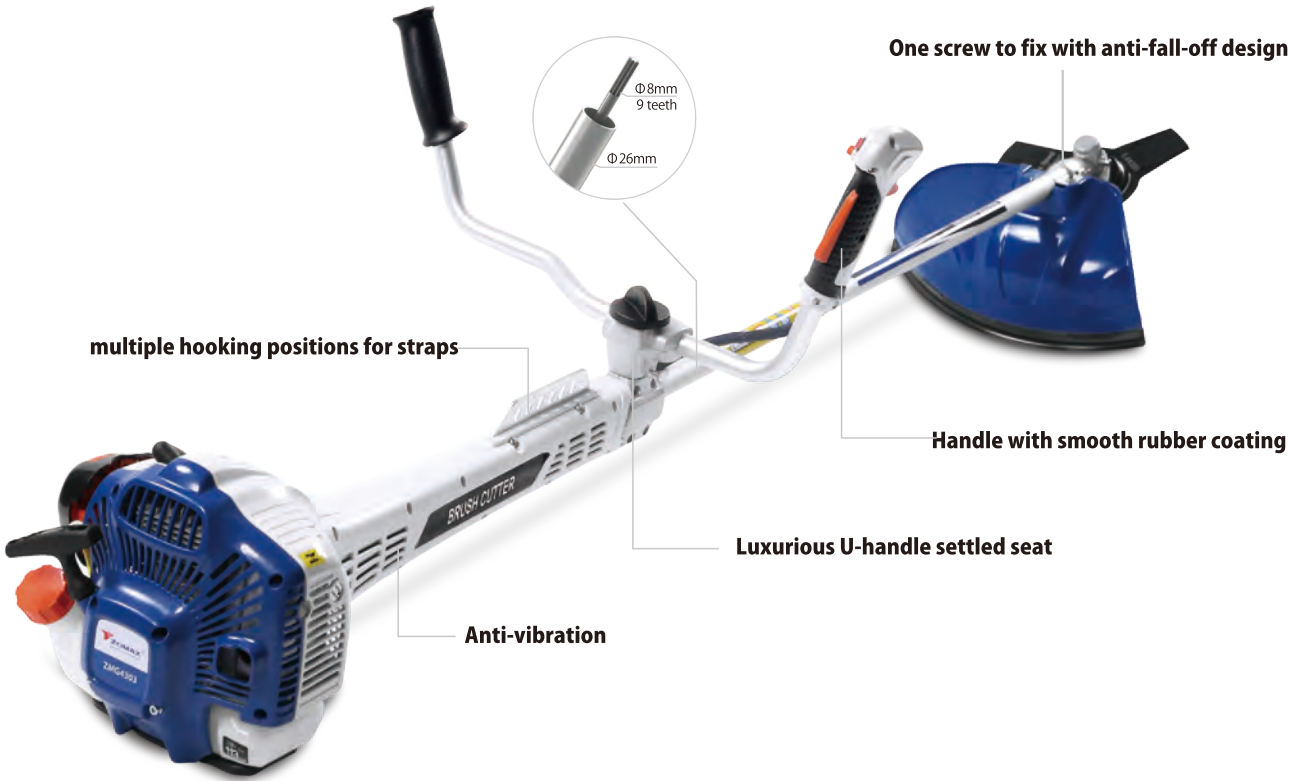

ZMG3303

CE EMC EuV EPA III 2 stroke

| | |
|-----------------------|---------------------------|
| Displacement | 32.6 cc |
| Bore / Stroke | Φ36 / 32 mm |
| Rated Power | 0.9 kW / 1.2 hp |
| Max Speed | 10,000 rpm |
| Idle Speed | 3,000 ± 300 rpm |
| Fuel tank Capacity | 650 ml |
| Dry Weight | 8.1 kg |
| Transmission System | Clutch+Hard Shaft+Gearbox |
| Working Shaft Lengths | 1,500 mm |



ZMG4303/5303

CE EMC EuV EPA III 2 stroke

| | | |
|-----------------------|---------------------------|---------------------------|
| Displacement | 42.7 cc | 51.7 cc |
| Bore / Stroke | Φ40 / 34 mm | Φ44 / 34 mm |
| Rated Power | 1.25 kW / 1.7 hp | 1.4 kW / 1.9 hp |
| Max Speed | 10,000 rpm | 10,000 rpm |
| Idle Speed | 3,000 ± 300 rpm | 3,000 ± 300 rpm |
| Fuel tank Capacity | 700 ml | 700 ml |
| Dry Weight | 8.4 kg | 8.4 kg |
| Transmission System | Clutch+Hard Shaft+Gearbox | Clutch+Hard Shaft+Gearbox |
| Working Shaft Lengths | 1,500 mm | 1,500 mm |



ZMG3603

CE EMC EuV EPA III 4 stroke

| | |
|-----------------------|---------------------------|
| Displacement | 35.8 cc |
| Bore / Stroke | Φ39 / 30 mm |
| Rated Power | 0.8 kW / 1.0 hp |
| Max Speed | 9,000 rpm |
| Idle Speed | 3,000 ± 300 rpm |
| Fuel tank Capacity | 650 ml |
| Dry Weight | 8.6 kg |
| Transmission System | Clutch+Hard Shaft+Gearbox |
| Working Shaft Lengths | 1,500 mm |

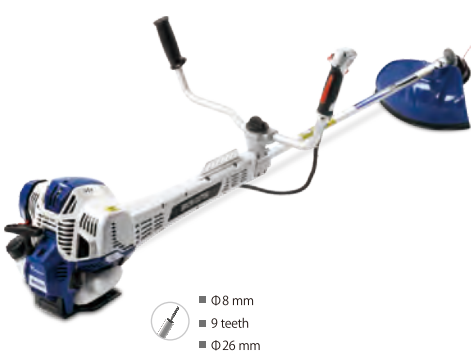

- Model + "T": Low emission engine with catalyst. Naming example: ZMG3302T
- Dry weight is without cutting attachments and safety guard.
- Reference weight: safety guard 390g, nylon head 360g, 3T blade 255g.
- Carton Dimension: 184*28.5* (10/28.5)cm whole packing.

- Standard Accessory:



05 SERIES

ZMG3305/4305/5305/3605

Backpack brush cutter suitable for farm-oriented properties, luxurious backpack with stable engine seat helps to reduce operator fatigue and provides a more comfortable working experience.

ZMG5305

The backpack brush cutter fixed engine on the support of ergonomic harness, not only keep the operator balance, but reduce the strain on the shoulders . with soft shaft part and loop handle, it can make quick work of those hard to reach areas mowers leave behind.



Luxurious backpack

Easy to install



loop handle

Simple backpack version available



One screw to fix with anti-fall-off design



ZMG3305

CE EMC EuV EPA III 2 stroke

| | |
|-----------------------|---------------------------|
| Displacement | 32.6 cc |
| Bore / Stroke | Φ 36 / 32 mm |
| Rated Power | 0.9 kW / 1.2 hp |
| Max Speed | 10,000 rpm |
| Idle Speed | 3,000 ± 300 rpm |
| Fuel tank Capacity | 650 ml |
| Dry Weight | 10.7 kg |
| Transmission System | Clutch+Hard Shaft+Gearbox |
| Soft Shaft lengths | 890 mm |
| Working Shaft Lengths | 1,330 mm |



- Φ 8 mm
- 9 teeth
- Φ 26 mm

Trimmers and
Brush cutters

ZMG4305/5305

CE EMC EuV EPA III 2 stroke

| | | |
|-----------------------|---------------------------|---------------------------|
| Displacement | 42.7 cc | 51.7 cc |
| Bore / Stroke | Φ 40 / 34 mm | Φ 44 / 34 mm |
| Rated Power | 1.25 kW / 1.7 hp | 1.4 kW / 1.9 hp |
| Max Speed | 10,000 rpm | 10,000 rpm |
| Idle Speed | 3,000 ± 300 rpm | 3,000 ± 300 rpm |
| Fuel tank Capacity | 700 ml | 700 ml |
| Dry Weight | 11.0 kg | 11.0 kg |
| Transmission System | Clutch+Hard Shaft+Gearbox | Clutch+Hard Shaft+Gearbox |
| Soft Shaft lengths | 890 mm | 890 mm |
| Working Shaft Lengths | 1,330 mm | 1,330 mm |



- Φ 8 mm / 8 mm
- 9 teeth / 9 teeth
- Φ 26 mm / 26 mm

ZMG3605

CE EMC EuV EPA III 4 stroke

| | |
|-----------------------|---------------------------|
| Displacement | 35.8 cc |
| Bore / Stroke | Φ 39 / 30 mm |
| Rated Power | 0.8 kW / 1.0 hp |
| Max Speed | 9,000 rpm |
| Idle Speed | 3,000 ± 300 rpm |
| Fuel tank Capacity | 650 ml |
| Dry Weight | 11.2 kg |
| Transmission System | Clutch+Hard Shaft+Gearbox |
| Soft Shaft lengths | 890 mm |
| Working Shaft Lengths | 1,330 mm |



- Φ 8 mm
- 9 teeth
- Φ 26 mm

■ Model + "T": Low emission engine with catalyst. Naming example: ZMG3302T
■ Dry weight is without cutting attachments and safety guard.
■ Reference weight: safety guard 390g, nylon head 360g, 3T blade 255g.
■ Carton Dimension: 38*28*60cm+153*13*10.5cm.

■ Standard Accessory:

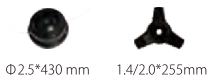

Φ 2.5*430 mm 1.4/2.0*255mm



06 SERIES

ZMG3306/4306/5306/3606

- Rotating shaft design makes the connecting with engine more flexible. Easy to control the bike handle.
- 2.0mm thickness shaft can take more tough tasks.

ZMG3606

Equipped with latest developed 4-stroke engine (139F), ZMG3606 is featured by low vibration and less noise. Its new design multihole clutch better to air cooling. The flexible rotating shaft can find a comfort cutting angle for you. It makes bike handle control almost effortless. Seriously consider the strong trimmer from Zomax professional line.



| | |
|--------------|-----------------|
| Displacement | 35.8 cc |
| Rated Power | 0.8 kW / 1.0 hp |
| Dry Weight | 7.8 kg |
| Engine | 4 stroke |



multiple hooking positions for straps

Exellent U-handle settled seat

One screw to fix with anti-fall-off design

Handle with smooth rubber coating

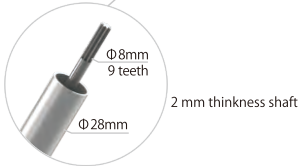

ZMG3306

CE EMC EuV EPA III 2 stroke

| | |
|-----------------------|---------------------------|
| Displacement | 32.6 cc |
| Bore / Stroke | Φ 36 / 32 mm |
| Rated Power | 0.9 kW / 1.2 hp |
| Max Speed | 10,000 rpm |
| Idle Speed | 3,000 ± 300 rpm |
| Fuel tank Capacity | 650 ml |
| Dry Weight | 7.3 kg |
| Transmission System | Clutch+Hard Shaft+Gearbox |
| Working Shaft Lengths | 1,500 mm |



- Φ 8 mm
- 9 teeth
- Φ 28 mm

ZMG4306/5306

CE EMC EuV EPA III 2 stroke

| | | |
|-----------------------|---------------------------|---------------------------|
| Displacement | 42.7 cc | 51.7 cc |
| Bore / Stroke | Φ 40 / 34 mm | Φ 44 / 34 mm |
| Rated Power | 1.25 kW / 1.7 hp | 1.4 kW / 1.9 hp |
| Max Speed | 10,000 rpm | 10,000 rpm |
| Idle Speed | 3,000 ± 300 rpm | 3,000 ± 300 rpm |
| Fuel tank Capacity | 700 ml | 700 ml |
| Dry Weight | 7.6 kg | 7.6 kg |
| Transmission System | Clutch+Hard Shaft+Gearbox | Clutch+Hard Shaft+Gearbox |
| Working Shaft Lengths | 1,500 mm | 1,500 mm |



- Φ 8 mm / 8 mm
- 9 teeth / 9 teeth
- Φ 28 mm / 28 mm



- Model + "T": Low emission engine with catalyst. Naming example: ZMG3302T
- Dry weight is without cutting attachments and safety guard.
- Reference weight: safety guard 390g, nylon head 360g, 3T blade 255g.
- Carton Dimension: 184*28.5* (10/28.5)cm whole packing.

Standard Accessory:



Φ 2.5*430 mm



1.4/2.0*255mm



refer to P49



12 SERIES

ZMG4312/ZMG5312/ZMG4313/
ZMG5313/ZMG4315/ZMG5315

- Split Starter Cover design, easy for maintenance.
- Upright Spark Plug design, improve ignition efficiency.

ZMG4312

New upgrade engine with new technology provides outstanding cutting performance, plenty of torque and fuel savings up to 15% compared with 02 series. Easy starting is achieved by primer on side and ergonomic optional bike handle makes work more enjoyable.



| | |
|--------------|------------------|
| Displacement | 42.7 cc |
| Rated Power | 1.35 kW / 1.8 hp |
| Dry Weight | 7.6 kg |
| Engine | 2 stroke |



Unique Air filter
Paper air filter offer excellent anti-dust

Long trigger, the trigger force is relatively reduced

Glue-covered handle for comfortable use



Lengthen connecting increasing fixed force ,
reducing deflection and vibration of
transmission rod

ZMG4312/5312

| | | |
|-----------------------|---------------------------|---------------------------|
| Displacement | 42.7 cc | 51.7 cc |
| Bore / Stroke | Φ40 / 34 mm | Φ44 / 34 mm |
| Rated Power | 1.35 kW / 1.8 hp | 1.5 kW / 2.0 hp |
| Max Speed | 11,000 rpm | 10,000 rpm |
| Idle Speed | 3,000 ± 300 rpm | 3,000 ± 300 rpm |
| Fuel tank Capacity | 900 ml | 900 ml |
| Dry Weight | 7.6 kg | 7.6 kg |
| Transmission System | Clutch+Hard Shaft+Gearbox | Clutch+Hard Shaft+Gearbox |
| Working Shaft Lengths | 1,500 mm | 1,500 mm |



- Φ8 mm
- 9 teeth
- Φ28 mm

ZMG4313/5313

| | | |
|-----------------------|---------------------------|---------------------------|
| Displacement | 42.7 cc | 51.7 cc |
| Bore / Stroke | Φ40 / 34 mm | Φ44 / 34 mm |
| Rated Power | 1.35 kW / 1.8 hp | 1.5 kW / 2.0 hp |
| Max Speed | 11,000 rpm | 10,000 rpm |
| Idle Speed | 3,000 ± 300 rpm | 3,000 ± 300 rpm |
| Fuel tank Capacity | 900 ml | 900 ml |
| Dry Weight | 8.5 kg | 8.5 kg |
| Transmission System | Clutch+Hard Shaft+Gearbox | Clutch+Hard Shaft+Gearbox |
| Working Shaft Lengths | 1,500 mm | 1,500 mm |



- Φ8 mm / 8 mm
- 9 teeth / 9 teeth
- Φ28 mm / 28 mm

ZMG4315/5315

| | | |
|-----------------------|---------------------------|---------------------------|
| Displacement | 42.7 cc | 51.7 cc |
| Bore / Stroke | Φ40 / 34 mm | Φ44 / 34 mm |
| Rated Power | 1.35 kW / 1.8 hp | 1.5 kW / 2.0 hp |
| Max Speed | 11,000 rpm | 10,000 rpm |
| Idle Speed | 3,000 ± 300 rpm | 3,000 ± 300 rpm |
| Fuel tank Capacity | 900 ml | 900 ml |
| Dry Weight | 9.9 kg | 9.9 kg |
| Transmission System | Clutch+Hard Shaft+Gearbox | Clutch+Hard Shaft+Gearbox |
| Working Shaft Lengths | 1,330 mm | 1,330 mm |



- Φ8 mm / 8 mm
- 9 teeth / 9 teeth
- Φ28 mm / 28 mm

- Model + "T": Low emission engine with catalyst. Naming example: ZMG3302T
- Dry weight is without cutting attachments and safety guard.
- Reference weight: safety guard 390g, nylon head 360g, 3T blade 255g.
- Carton Dimension: 184*28.5* (10/28.5)cm whole packing.

Standard Accessory:



Φ2.5*430 mm



1.4/2.0*255mm



refer to P49



45 SERIES

ZMG4502/ZMG4503/4505

- Split Starter Cover design, easy for maintenance.
- Upright Spark Plug design, improve ignition efficiency.

ZMG4502

Upgraded Engine with new Technology provides outstanding cutting performance, 30% power boost and less weight guarantee smoothly using in heavy duty jobs. Equipped with Easy Starter and Fuel Primer, enable your start more comfortable.



| | |
|--------------|----------------|
| Displacement | 41.5cc |
| Rated Power | 1.6 kW / 2.2hp |
| Dry Weight | 6.6 kg |
| Engine | 2 stroke |



Non-woven Fabric and
Sponge Composite air filter

Excellent U handle settled seat

Separated Starter
Easy for maintenance

Brand New Engine Structure
Guarantee higher power

ZMG4502

CE EMC EuV 2 stroke

| | |
|-----------------------|---------------------------|
| Displacement | 41.5cc |
| Bore / Stroke | Φ40 / 33 mm |
| Rated Power | 1.6 kW / 2.2 hp |
| Max Speed | 11,000 rpm |
| Idle Speed | 3,300 ± 300 rpm |
| Fuel tank Capacity | 900 ml |
| Dry Weight | 6.6 kg |
| Transmission System | Clutch+Hard Shaft+Gearbox |
| Working Shaft Lengths | 1,500 mm |

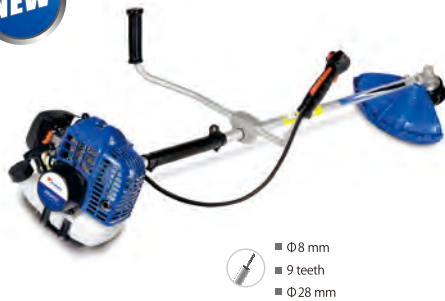

ZMG4503

CE EMC EuV 2 stroke

| | |
|-----------------------|---------------------------|
| Displacement | 41.5cc |
| Bore / Stroke | Φ40 / 33 mm |
| Rated Power | 1.6 kW / 2.2 hp |
| Max Speed | 11,000 rpm |
| Idle Speed | 3,300 ± 300 rpm |
| Fuel tank Capacity | 900 ml |
| Dry Weight | 7.6 kg |
| Transmission System | Clutch+Hard Shaft+Gearbox |
| Working Shaft Lengths | 1,500 mm |



ZMG4505

CE EMC EuV 2 stroke

| | |
|-----------------------|---------------------------|
| Displacement | 41.5cc |
| Bore / Stroke | Φ40 / 33 mm |
| Rated Power | 1.6 kW / 2.2 hp |
| Max Speed | 11,000 rpm |
| Idle Speed | 3,300 ± 300 rpm |
| Fuel tank Capacity | 900 ml |
| Dry Weight | 9.0 kg |
| Transmission System | Clutch+Hard Shaft+Gearbox |
| Working Shaft Lengths | 1,500 mm |



Standard Accessory:



Φ2.5*430 mm



1.4/2.0*255mm



refer to P49

Accessories & head Option

Item Code: 01-H

Basic support-single harness

The single harness provides the basic support with padding built into the shoulder strap for additional comfortable. Suitable for light weight machine.



Item Code: 05-H

Double shoulder harness

With a shield design as a soft, a more comfortable touching to your hip.



Item Code: 09-H

Double shoulder harness

For conveniently transporting tools, features two sections and can be easily attached to the universal and forestry harnesses.



Item Code: 12-H

Double shoulder harness

New advance plus universal harness.



Auto cut mowing head
Head tapping, and line automatically mowing, for cutting tall grass.

For cutting medium to short tangled grass with evenly distributed vegetation.



2 teeth grass cutting blade

For thick vegetation, rough grass cutting.



3 teeth grass cutting knife

For thinning and cutting brush wood, under wood or thick thorny hedges.



3 teeth grass cutting blade

For thick bushes, thin tree or weeds cutting.



80 teeth grass cutting blade